

line

material aluminium coated
 weight 1,75 kg/lm - 1,16 lb/feet
 voltage 24Vdc
 max wattage 240W on single circuit
 circuits 2
 dimming 1-10V / 0-10V / Dali
 certifications CE ENEC
 classifications IP20

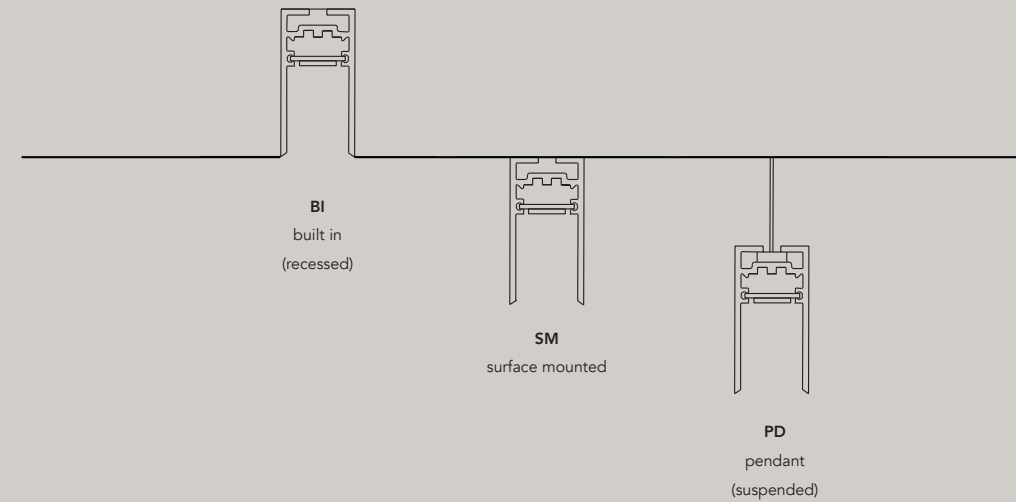
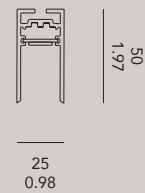

L.L.C.T

Length	4000 300 - ...	standard length in mm custom length in mm
Color body	BK WH AL	black matt ral 9011 white matt ral 9016 aluminium color ral 9006 (on request only)
Type mounting	BI SM PD	built in (recessed) surface mount pendant (suspended / standard cable of 2m included)

Brackets

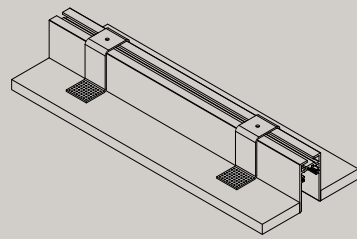
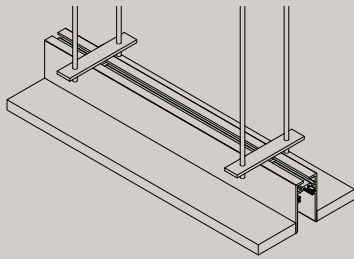
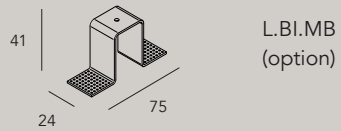
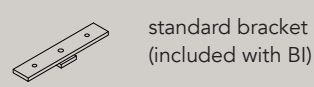

Connectors

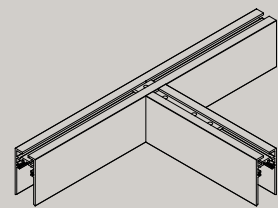
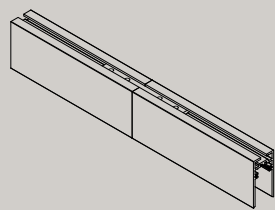
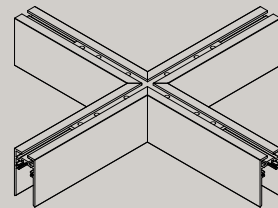
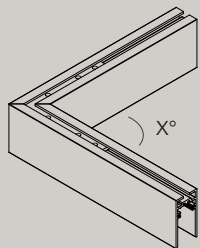
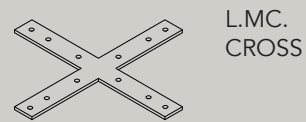
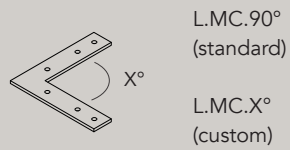

Round Corner

End Cap

Pendant Extension Cable

L.CORN.RND.WH
L.CORN.RND.BK

L.EC.WH
L.EC.BK
L.EC.AL

PD.EC.8M

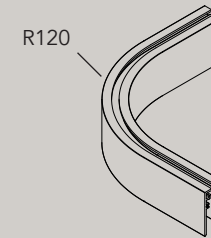

L.CP.L.C

Cover profile

Length	1000 2000 4000	1000 mm - 39,37 in 2000 mm - 78,74 in 4000 mm - 157,48 in
--------	---	---

Color	BK WH AL	black matt ral 9011 white matt ral 9016 aluminium color ral 9006 (on request only)
-------	-------------------------------------	---

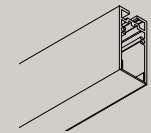

power supply ceiling box (only for surface mounted version)

PSCB.BK	color black
PSCB.WH	color white

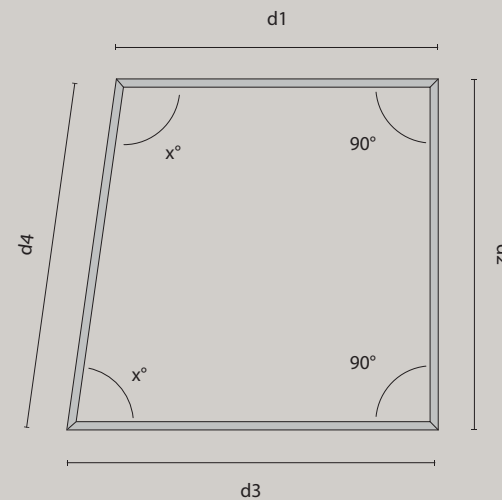

Mention the outside dimensions of the tracks and the inner corners